

### **Program Summary:**

Live Oak Elementary is situated on a 30 acre abandoned agricultural tract near Albany, Georgia. Challenged by the Dougherty County School System (DCSS) to design “a school like no other in the State of Georgia,” the design team sought to create a school strongly rooted in its sense of place while underscoring the DCSS motto “Pursuing Excellence” by way of careful site evaluation, program analysis, and thoughtful form-giving.

### **Program Statement:**

The school's organization was driven by the desire to provide abundant high-quality light to the learning units. In order to achieve this, three (3) two-story rectangular classroom “houses” were oriented east-west and arranged around courtyards. Classrooms were provided with two oversized window openings totaling over 90 square feet and oriented north or south. South-facing windows were equipped with continuous sunshades to filter glare and mitigate solar gain. Each “house” was provided a unique bold coloration to aid wayfinding and help students identify with “their house.” The “houses” were linked with one another and with other programmatic elements by an internal street dubbed “the runway” stretching north-south. The eastern edge of the runway was conceived as a four foot thick spine running the entire length of the school to accommodate building services such as mechanical and electrical closets and duct chases. The spine manifests itself on the exterior as a series of forty-foot high concrete planes which are crimped to allow the building to take on a more natural, almost organic shape in plan.

# T08.01

Building Area: (sf)  
**89,300gsf**

Cost per Square Foot:  
**\$163**

Construction Cost  
**\$14,567,132**

Date of Completion:  
**July 2007**



## T08.02

The main entrance of the school reinforces an agrarian tectonic in detail via the canopy. The custom steel canopy is intertwined with concrete and contributes toward celebration of the American flag.

## T08.03

First Floor Plan that delineates the spine scheme with the Administration, Cafetorium, and Gymnasium at the “head” and the Media Center and the “tail.” Classroom wings stem from the spine in an effort to utilize natural light while also providing an identity for each class.

Preliminary massing model reinforces the utilization of agrarian forms in a manner that is balanced and hierarchical.

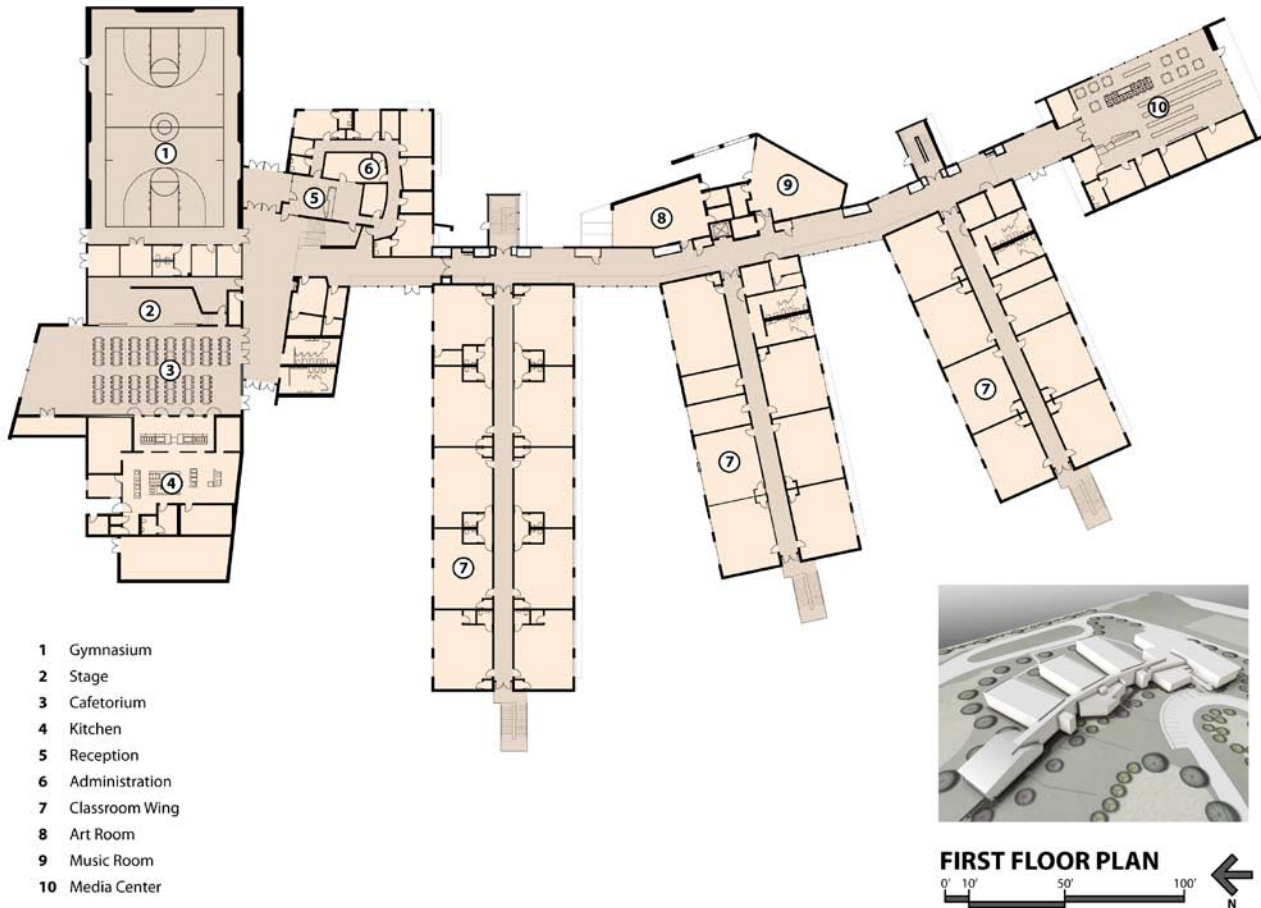

## T08.04

Second Floor Plan that is open to below at certain vantage points along the spine. The spine also provides for art alcoves and places for informal gathering. The classroom wings stack with the egress stairs emerging from the interior in a manner that suggests the linear movement in each wing corridor.

Preliminary massing model reinforces the utilization of agrarian forms in a manner that is balanced and hierarchical.

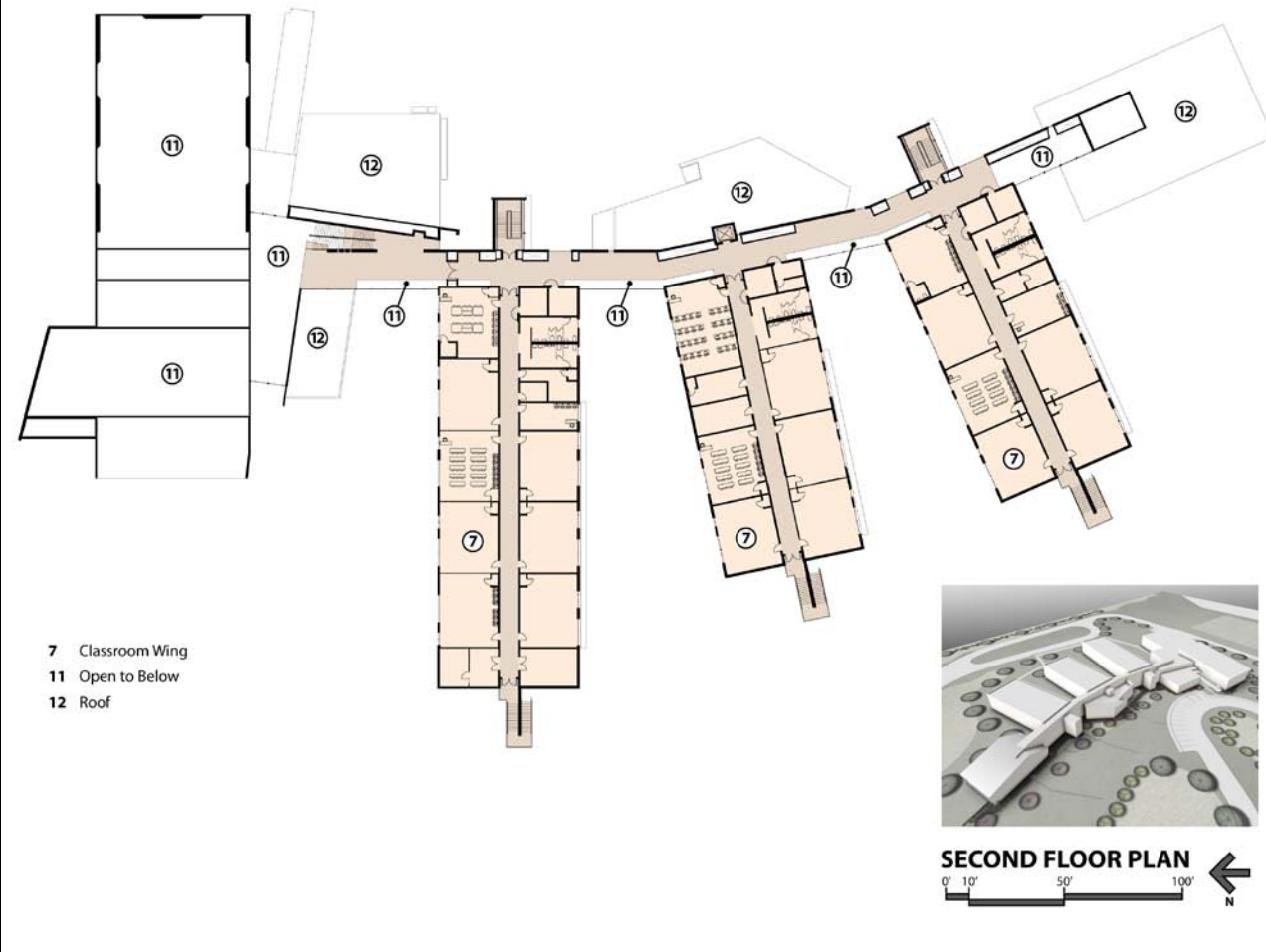

## T0.05

The austere concrete form that forms the spine and fronts the public side of the building is adorned with colorful masses that contain the Media Center and the Arts.





## T08.06

A double height space provides an easy understanding of how to access all areas of the school. The main stair and balcony is also used for large group meetings. Ornamental stairs and railings are assembled via the use of simple steel shapes common in rural Georgia.

Careful attention to lighting selection throughout the school as evident in this slide. Lighting reinforces direction, hierarchy, and scale.



## T08.07

In contrast to the public side of the school, the classroom wings are colorful and large in scale. The masses are set off at the grade plane with the use of river rock found locally. The stucco finish system is broken down in scale with reveals. Sunshades clad the southern sides of the masses to assist with glare control and add detail.



## T08.08

This detail shot depicts the use of simple materials such as grating to provide shading at the Art Room. Punched openings in the cast in place concrete provide for random views throughout the entire spine.



## T08.09

The Gymnasium is graced with an abundance of north light. All exposed steel structure is painted dark gray in an effort to convey its utilitarian properties and to allow the kids and the activities to stay the focus.

## T08.10

View from the spine showing an “intersection” with a grade identifier. Simple materials and color add movement and contribute not only to an invigorating daily experience, but also toward a stimulating learning environment.



## T08.11

Main entrance to the Media Center which is the “exclamation point” of the massing. Resin panels and brushed aluminum letters are thoughtfully composed not only for signage, but for large scale graphics.

Recessed light fixtures reinforce circulation within the Media Center and draw the student through the entire space.





## T08.12

Exterior view of the Media Center recalls simple agrarian metal panel and form while the stairways are illuminated and clad with glass. The concrete ribbon that forms the west face of the spine extends beyond the building and disappears into the earth.

Landscaping is organized in rows and is differentiated from natural plantings at the grade plane with stone.

Project Name:  
Live Oak Elementary

Project Location:  
Albany, Georgia

Owner/Client:  
Dougherty County School System

Architect(s) of Record:  
2WR Inc.  
166 Commerce Street  
Montgomery, Alabama 36104

Project Team:  
**Project Executive:**  
W. Michael Watson, AIA  
**Principal-In-Charge:**  
Sam Andras, AIA  
**Principal | Technical Design:**  
Michael Starr, AIA | LEED AP  
**Principal | Design:**  
Scott Allen, AIA  
**Project Coordinators:**  
Elsi Eckstein, Associate AIA  
Heather Knowles, Associate AIA  
Patrick Whitehead

Landscape Architect:  
2WR Inc.

Consultants:  
Civil: Stevenson & Palmer  
Structural: Kun-Young Chiu  
MEP: Andrews Hammock & Powell  
Kitchen: Camacho and Associates

General Contractor:  
Construction CGM

Photographer(s):  
(please list which specific slides get credited to each  
photographer(s) listed)  
Jim Roof Creative

# T08.x

## Project Identification Slide

This slide will not be seen by the judges. It replaces what in past years has been in the sealed envelope.

Please fill out the information requested to the left. As with other slides please set the correct Entry Number above; OK to leave slide# as "x"

Some of this information will be added to the slides when used for the Honor Awards Presentation at the Awards Gala.

Note: on this slide if you run out of space please adjust font size as necessary or move more information to the second column.

Please deliver your completed PowerPoint file to 260 Commerce Street, Suite 200, Montgomery, AL, 36104 on a CD. Also include this identification information in a sealed envelope bearing only the code number on front.