

T10.01

Program Summary – Rework a uniform façade and interior circulation to allow an existing structure to better respond to its urban circumstances and offer identity to two prominent civic tenants.

Program Statement – The existing Dexter Plaza complex encounters a number of different urban circumstances within the city block it occupies. Criticisms include the fact that it maintains a generally uniform façade, it is inward facing, entry points are not clear, internal circulation is confusing, and the building’s exterior is cold and hard with an uncomfortable cantilever. Our research indicated the historic and civic importance of the fountain Avenue grid. Internal site lines take advantage of the fountain plaza in front of the building to be at least as significant to this central hinge location within the urban grid as any of the buildings around it. It was important that the Questplex structure provide clear connections to the plaza and surrounding blocks to encourage activity and comfort of use. We addressed varying urban scales and site lines, within and around the block. Through its transparency, use of warmer materials, and more appropriately defined volumes, the proposed structure relays a comfort level to its occupants, neighboring street life, and neighboring structures while at the same time generating a more evident civic prominence. At the most prominent location the structure is shifted to better react to the Dexter Avenue grid. Internal site lines take advantage of the fountain in the plaza as a spatial reference for orientation.

BUILDING AREA: (SF)
N/A

COST PER SQUARE FOOT:
N/A

CONSTRUCTION COST
N/A

DATE OF COMPLETION:
N/A



Diagrams: Building/Site Conditions

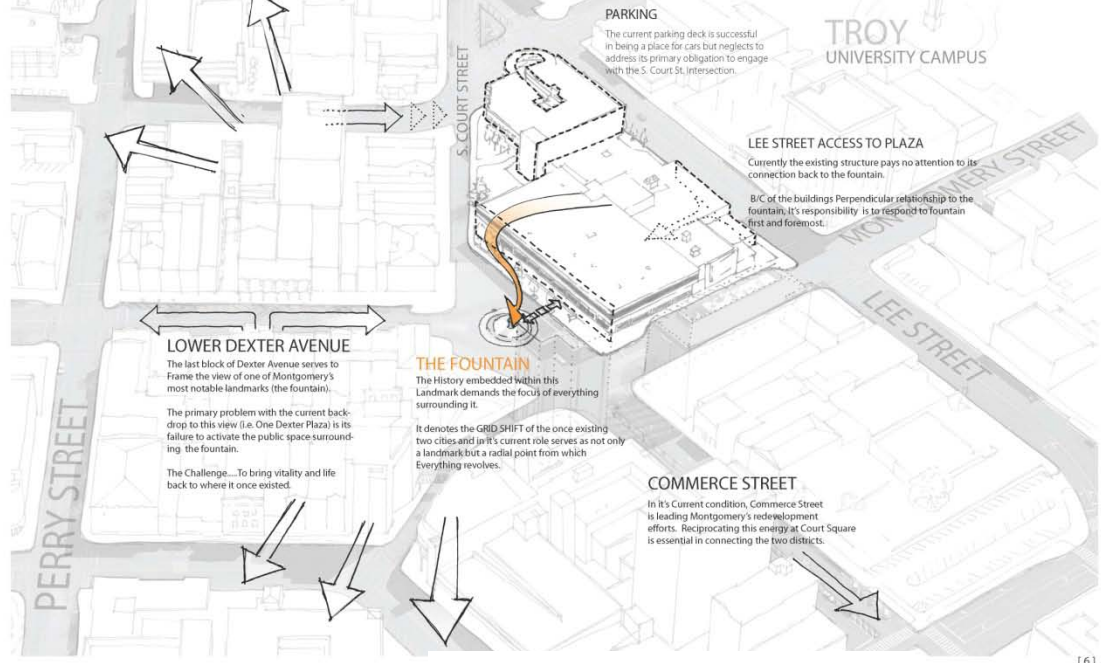

[6]

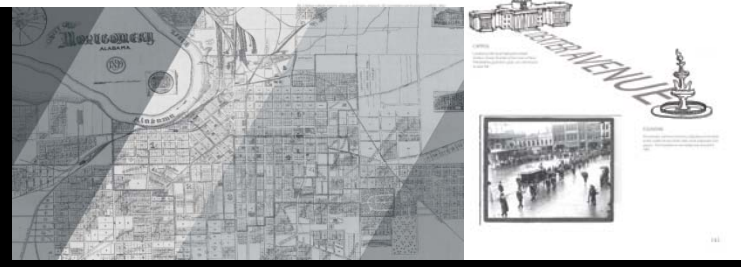

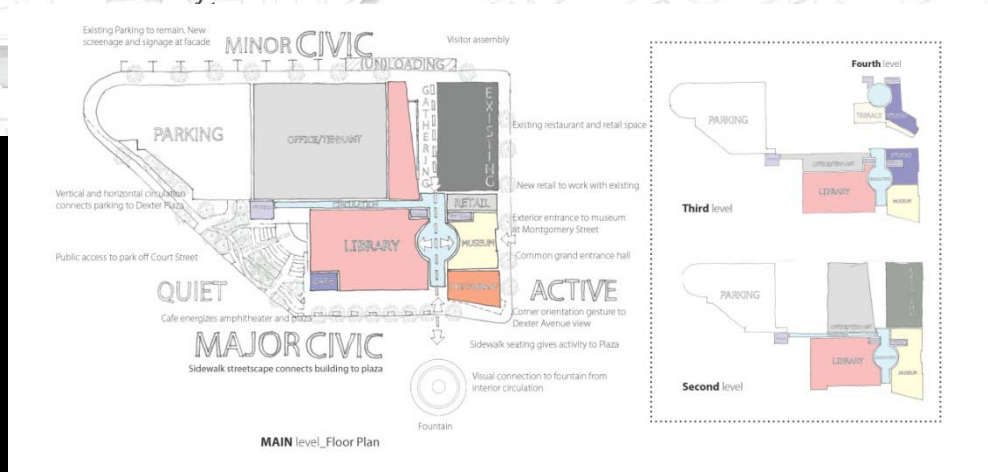
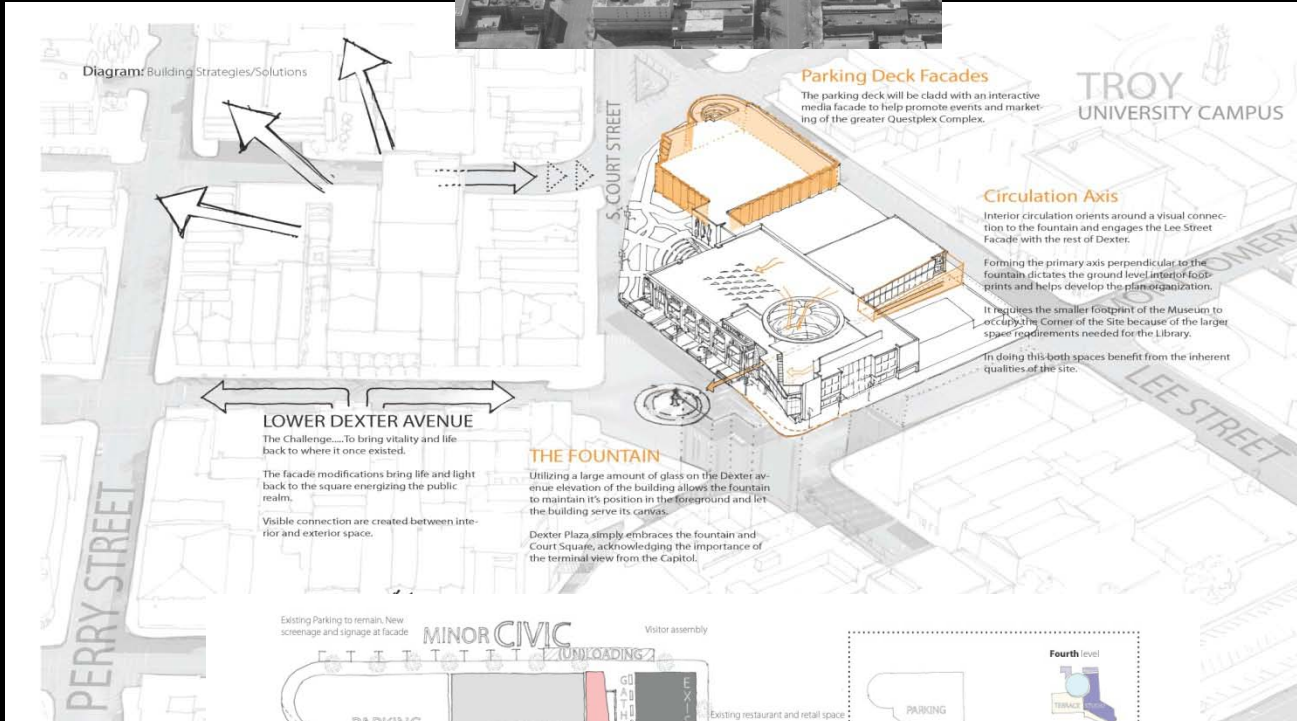

T10.04

DEFINED BUILDING, ENTRANCE
DEXTER AVENUE ELEVATION

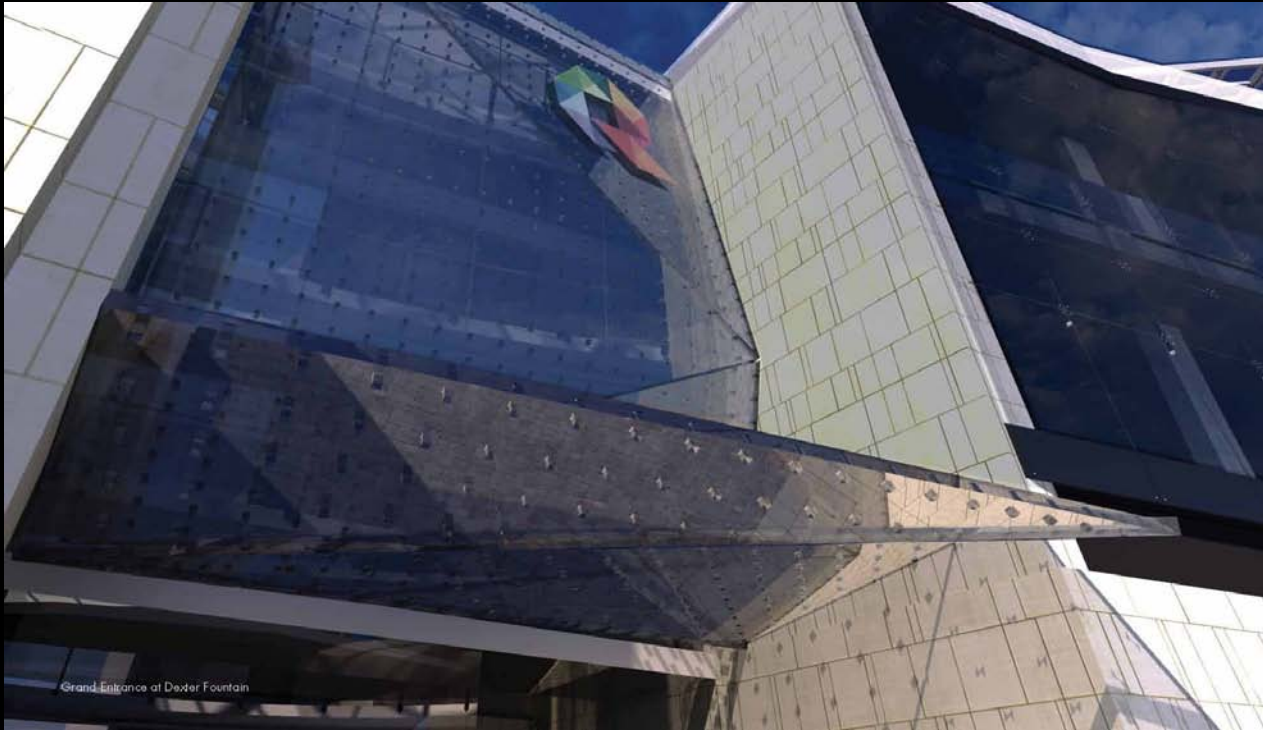

Grand Entrance at Dexter Fountain

T10.05

DEXTER AVENUE AND COURT STREET ELEVATION STUDIES

BUILDING COMPONENTS PRESENT VARIOUS SCALES TO RESPOND TO THE URBAN AND PEDESTRIAN CONTEXT

WARMER MATERIALS AND MORE DETAILED SCALE ARE ASSOCIATED WITH THE PEDESTRIAN ZONES.

DIFFERENTIATION OF FAÇADE ELEMENTS REDUCES THE BUILDING SCALE. RELATE TO THE NEW USER FUNCTIONS, AND RECALL THE VARIATIONS IN PREVIOUS BUILDING FACADES THAT ONCE OCCUPIED THE SITE.

NEW ENTRANCE IS CLEARLY DEFINED AND AXIALLY CONNECTS TO BOTH INTERIOR ROTUNDA, LEE AND MONTGOMERY STREETS BY USE OF TRANSPARENT MATERIALS

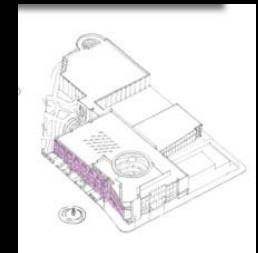

T10.06

DEXTER ENTRANCE VIEW



SOFT AND HARDSCAPING
CREATE GATHERING AND
CIRCULATION ZONES. TRAFFIC IS
SEPARATED FROM PEDESTRIANS
BY CONTAINED PLANTING.

OUTDOOR CAFÉ SPACES ARE
LOCATED IN BOTH COVERED AND
UNCOVERED AREAS AND GIVE
LIFE TO THE STREETS AND PLAZA.

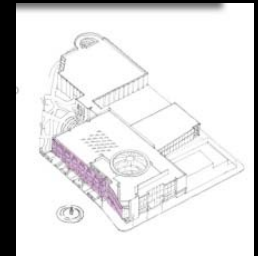



T10.07

DEXTER AVENUE PERSPECTIVE
AND DEXTER PLAZA AT
NIGHT

VIEW EMPHASIZES
IMPORTANCE OF THE
FOUNTAIN AS DEXTER
AVENUE TERMINUS

GLAZING ALLOWS FOUNTAIN
TO BE FRAMED WITH MINIMAL
VISUAL COMPETITION AND
REFLECTS THE HISTORIC
PROPERTIES OF DEXTER
AVENUE

GLAZING AFFORDS VIEW
BACK TO DEXTER AVENUE

READER BOARD RECALLS THE
ORIGINAL USE OF COURT
SQUARE AS A PLACE TO
RECEIVE AND DISTRIBUTE
NEWS AND INFORMATION.

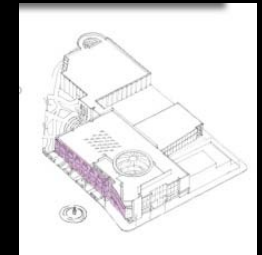

T10.08

DEXTER PLAZA AT NIGHT



BUILDING POSSESSES CIVIC STATURE WHILE STILL APPROACHABLE.

WINDOWS AFFORD BOTH VIEWS INTO AND OUT OF BUILDING

WINDOWS GIVE LIGHT AND LIFE BACK TO PLAZA.

VIEW EMPHASIZES IMPORTANCE OF THE FOUNTAIN AS DEXTER AVENUE TERMINUS

ROOF TOP TERRACE AND LIBRARY BALCONIES AFFORD VIEWS OF SPECIAL EVENTS AND PARADES DOWN DEXTER AVENUE AND COMMERCE STREET

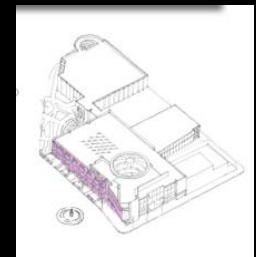

T10.09

MONTGOMERY STREET, COURT STREET AND LEE STREET ELEVATION STUDIES

MATERIALS, DESIGN WHIMSY, LANDSCAPING, AND SIGNAGE SOFTEN EXISTING HARD WALL CONSTRUCTION.

CLEARLY DEFINED ENTRANCE AND TRANSPARENCY CONNECT MONTGOMERY STREET ENTRANCE TO ROTUNDA.

COURT STREET AMPHITHEATER OPENS TO LIBRARY AND IS IN CLOSE PROXIMITY TO COFFEE SHOP

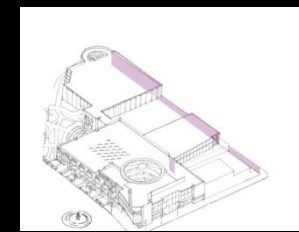
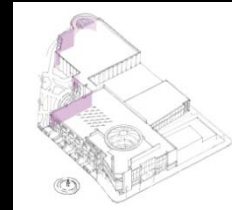
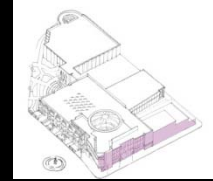

T10.10

LEE STREET CONNECTION

BUILDING ENTRANCE PROVIDES VISUAL CONNECTION TO FOUNTAIN AT COURT SQUARE AND DEXTER AVENUE.

COURT PROVIDES SAFE COLLECTION POINT FOR CHILDREN DEPARTING AND BOARDING BUSES AND OTHER GROUP FUNCTIONS.

GLAZED SPLAYED WALL HELPS TO RELIEVE COMPRESSION OF EXTERIOR SPACE, REFLECTS HISTORIC BRICK WALL AND DIRECTS VISITORS TO THE ROTUNDA

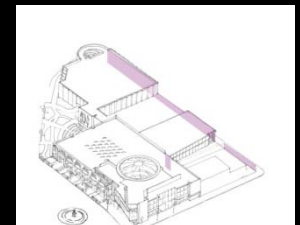

T10.11

COURT STREET
AMPHITHEATER, POCKET PARK
AND VIEW TO COMMERCE
STREET

PARK IS LOCATED IN QUIET
ZONE ADJACENT TO LIBRARY
INTERIOR ATRIUM AND
READING ZONES

SCULPTURE ENRICHES PARK
AND CONNECTS EXHIBIT AND
KINETIC ART POSSIBILITIES
WITH CHILDREN'S MUSEUM

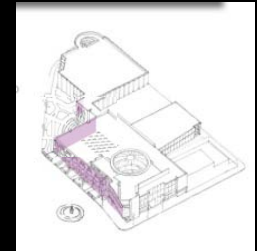

T10.12

ROTUNDA - CONNECTS
INTERIOR CIRCULATION AND
BRINGS DAYLIGHT TO
BUILDING CORE

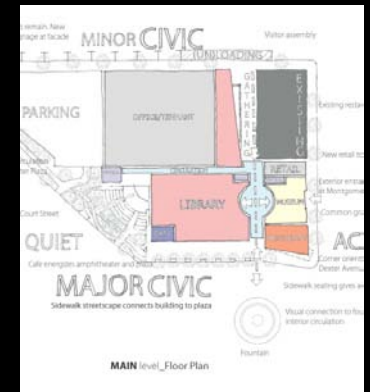

PROJECT NAME:
QUESTPLEX EXTERIOR IMPROVEMENTS
COMPETITION

PROJECT LOCATION:
COURT SQUARE, MONTGOMERY AL

OWNER/CLIENT:
CITY OF MONTGOMERY

ARCHITECT(S) OF RECORD:
(NAMES AND ADDRESSES)
BROWN CHAMBLESS ARCHITECTS

PROJECT TEAM:
DON BROWN, FAIA
JOHN CHAMBLESS, JR. AIA

DAWN CROW, ASSOC. AIA
SOMMERVILLE HILL, ASSOC. AIA
WILBUR HILL, ASSOC. AIA
MIKE SHOWS
ROBERT SPROULL, ASSOC. AIA
JOHN VERES
PAUL ZANGLIN, ASSOC. AIA, LEED AP

STEPHANIE BRAGG
ROSEMARY TRAVIS

LANDSCAPE ARCHITECT:
N/A

CONSULTANTS:
NATHAN NORRIS, PLACEMAKERS

GENERAL CONTRACTOR:
N/A

PHOTOGRAPHER(S):
(PLEASE LIST WHICH SPECIFIC SLIDES GET CREDITED TO
EACH PHOTOGRAPHER(S) LISTED)
N/A

NOTE ALL IMAGES MAY BE USED PUBLICALLY
EXCEPT SLIDE 12.

Tio.x