

Program Summary:

This 4200 SF private residence utilizes sustainable design strategies to achieve a compelling integration of interior and exterior living spaces on a beautiful woodland site in the rural periphery of Auburn, Alabama.

Program Statement:

The House on Hickory Hill is designed to take full advantage of a beautiful woodland site, leverage natural systems (prevailing winds, sun path, and shade tree canopies), and create multiple zones for family life, social activities, and creative work.

The solution that evolved from these goals is a four bedroom, 4200 SF home that arrays the primary program areas into two separate structures connected by a generous porch and covered breezeway. These two structures are offset along an east-west axis to frame a courtyard space on the west side and an arrival court on the east side. Each wing of the home is configured as a slender bar, allowing for passive cross ventilation and choreographed views into the landscape from two sides of every room. The main structure contains the primary program spaces, including living, dining, kitchen and 3 bedrooms, while the other structure contains a family room, guest bedroom, design studio, and garage. Simple exterior materials and iconic vernacular forms tie the home to its rural East Alabama setting.

The green design aspects of the home rest on two strategies. Passive ventilation and day lighting are facilitated by narrow cross sections and generous windows. The central connecting porch space also captures the prevailing west to east breezes. Complementing these features are a well-insulated building envelope, optimal solar orientation, and high-efficiency mechanical systems working in concert to minimize the energy needed to cool and heat the home.

T03.01

Building Area: (sf)
4200 sf

Cost per Square Foot:
Cost withheld by Client

Construction Cost
Cost withheld by Client

Date of Completion:
February, 2009



T03.02

As illustrated by the diagram on the right, the house form develops from an effort to split the traditional 2-room deep plan into two narrower wings. The 21 ft. cross section of these wings allows for ample day lighting and natural cross-ventilation.

Each wing is sited with the long axis oriented east/west to optimize solar exposure, and the wings are shifted along this line to create two courts: one of which becomes an entry court and the other a garden/lawn.

The two off-set wings are connected by a covered 4-season porch and a breezeway.

A tree protection plan was utilized to minimize site disruption, and the landscape plan emphasizes native plant materials and minimal irrigation.

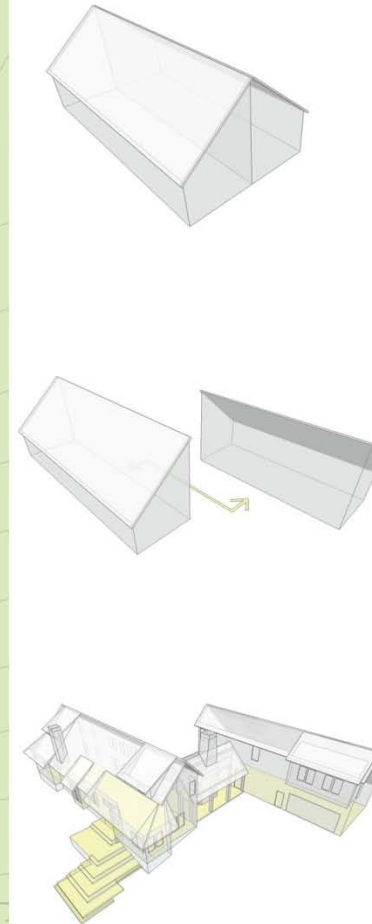

T03.03

The main program spaces, including living, dining, kitchen and 3 bedrooms are found in the front wing of the house. The rear wing contains a family room, guest bedroom, design studio, and garage.

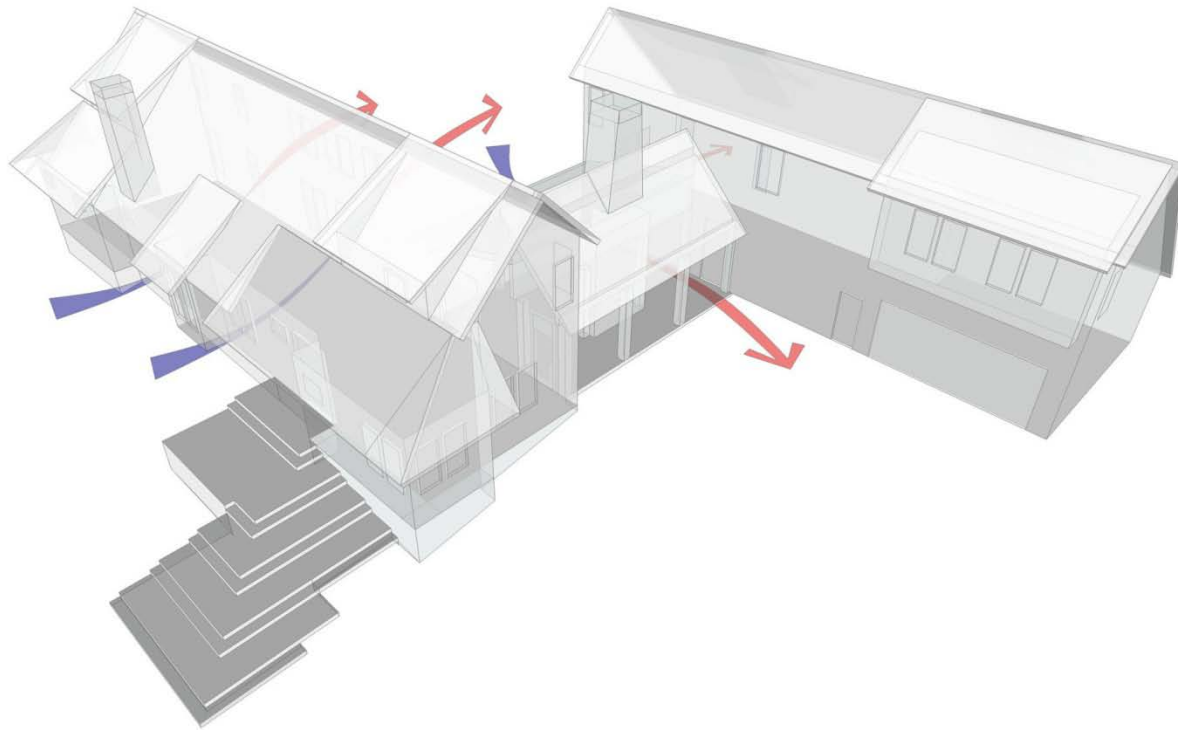

UPPER FLOOR PLAN



MAIN FLOOR PLAN

- 1. ENTRY PORCH
- 2. DINING AREA
- 3. LIVING AREA
- 4. MASTER SUITE
- 5. BATHROOM
- 6. KITCHEN
- 7. FAMILY ROOM
- 8. GARAGE
- 9. GARDEN



T03.04

Front Entry and transition to east court





T03.05

East side entry court

T03.06

Above:
Dining Area.
Ample windows and narrow
cross-section allows for day
lighting

Below:
Double height space in main
wing facilitates “chimney-
effect” ventilation.



T03.07

Above:
Galley Kitchen & Breakfast
Area in main wing

Below:
Entry Hall leads directly to
connecting porch





T03.08

Connecting porch opens to west side garden court.

T03.09

Evening views of connecting porch and west-side garden court



T03.10

Above:
The room-scaled porch serves as an extension of the network of social spaces that interconnect on the ground level.

Below:
The porch can be converted from an open configuration to a fully-enclosed screen porch via a series of sliding and hinged panels. Together with the large wood-burning fireplace, these features serve to make this a 4-season outdoor living room.



T03.11

View of connecting porch at dusk.



Project Name:

The House on Hickory Hill

Project Location:

Auburn, Alabama

Owner/Client:

David and Annie Hinson

Architect(s) of Record:

Hinson and Dagg Architects

David Whatley Hinson, FAIA

Christian Thomas Dagg, AIA

1487 McCurry Lane

Auburn, Alabama 36830

Project Team:

Gorham Bird

Interior Consultant:

Annie Hinson

Auburn, Alabama

General Contractor:

John Stewart

Auburn, Alabama

Photographer(s):

All photographs taken by:

Daniel Wicke

Newbern, Alabama